

APPENDIX C

Plans of Chesham Town Parking Review Phase 2 Proposed waiting restrictions (Parking Traffic Regulation Order Tiles)

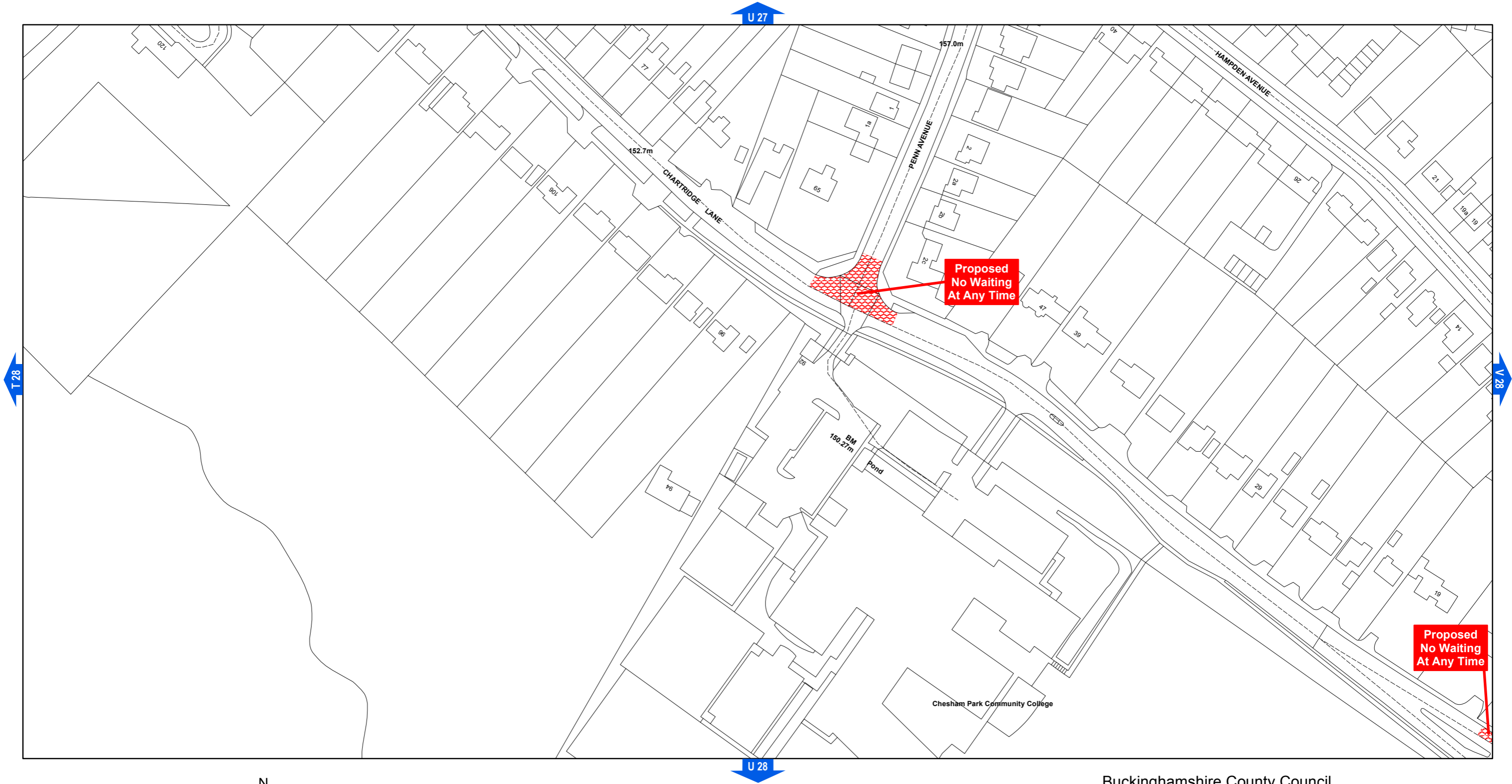

SCALE - 1:1250 At A3



KEY

- Existing Restriction
- Proposed Restriction



Buckinghamshire County Council
County Hall
Walton Street
Aylesbury
Buckinghamshire HP20 1UY

The Buckinghamshire County Council (Chiltern District) (Consolidation) Order 2010

Produced from Ordnance Survey 1:1250 mapping with permission of the Controller of Her Majesty's Stationery Office © Crown Copyright. Unauthorised reproduction infringes Crown Copyright and may lead to prosecution or civil proceedings. © Buckinghamshire County Council. 100021529 2016

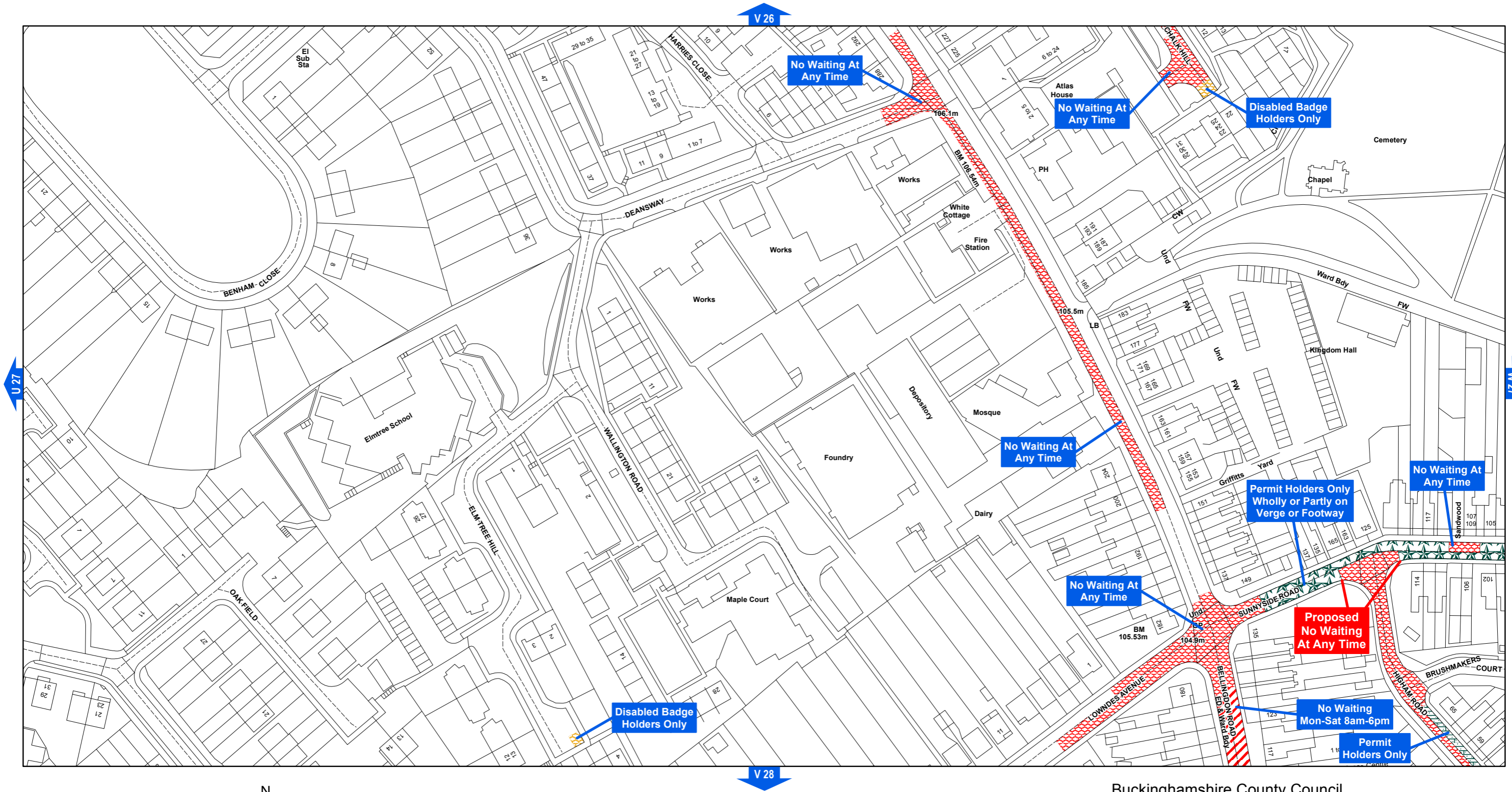

SCALE - 1:1250 At A3



KEY

- Existing Restriction
- Proposed Restriction



The Buckinghamshire County Council (Chiltern District) (Consolidation) Order 2010

Buckinghamshire County Council
 County Hall
 Walton Street
 Aylesbury
 Buckinghamshire HP20 1UY

Produced from Ordnance Survey 1:1250 mapping with permission of the Controller of Her Majesty's Stationery Office © Crown Copyright. Unauthorised reproduction infringes Crown Copyright and may lead to prosecution or civil proceedings. © Buckinghamshire County Council. 100021529 2016

AREA CODE: V 28

SHEET REVISION NUMBER - 3

CONSULTATION PLAN

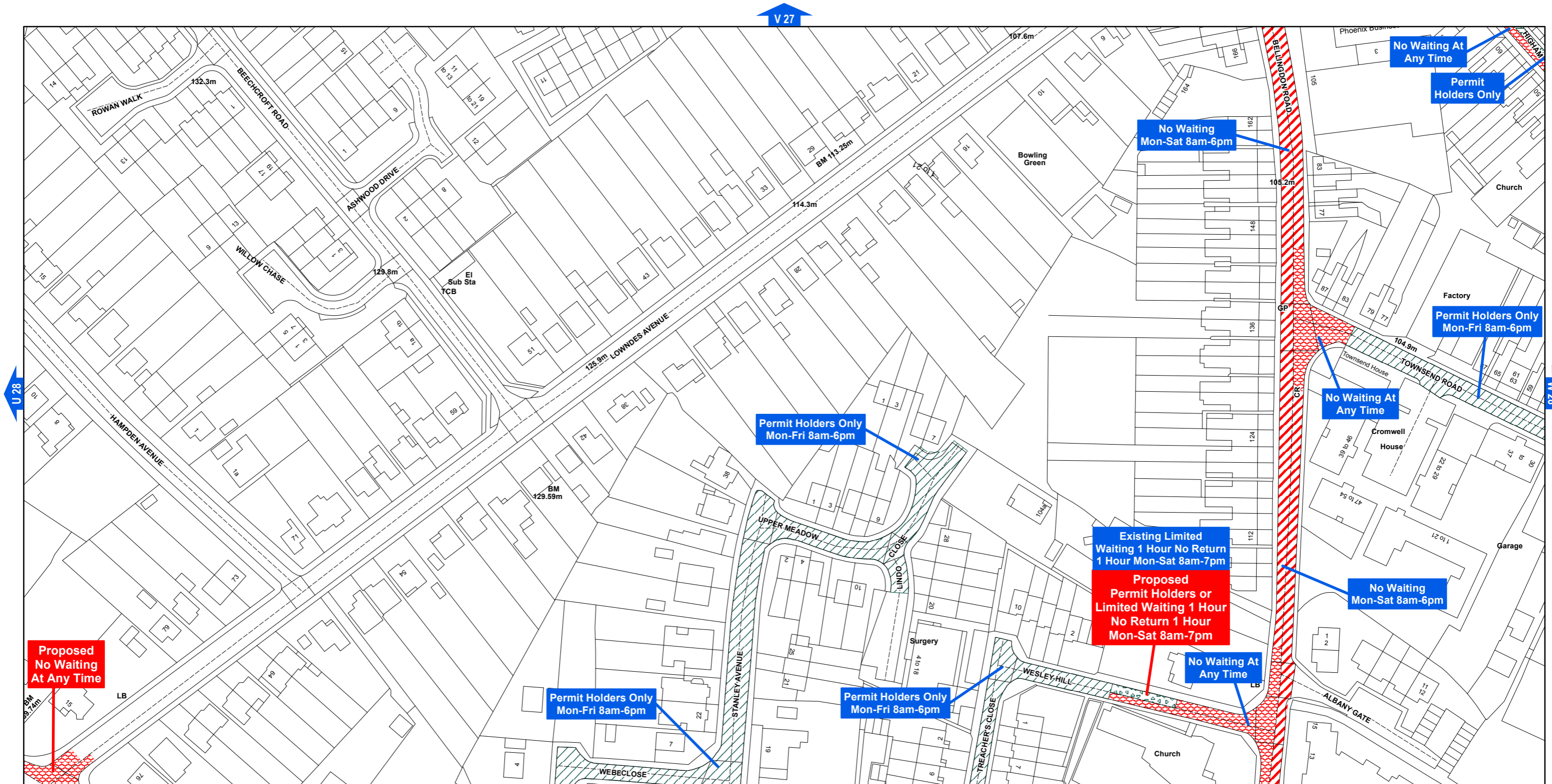

SCALE - 1:1250 At A3



KEY

- Existing Restriction
- Proposed Restriction

The Buckinghamshire County Council (Chiltern District) (Consolidation) Order 2010



Buckinghamshire County Council
 County Hall
 Walton Street
 Aylesbury
 Buckinghamshire HP20 1UY

Produced from Ordnance Survey 1:1250 mapping with permission of the Controller of Her Majesty's Stationery Office © Crown Copyright. Unauthorised reproduction infringes Crown Copyright and may lead to prosecution or civil proceedings. © Buckinghamshire County Council. 100021529 2016

AREA CODE: V 29

SHEET REVISION NUMBER - 4

CONSULTATION PLAN

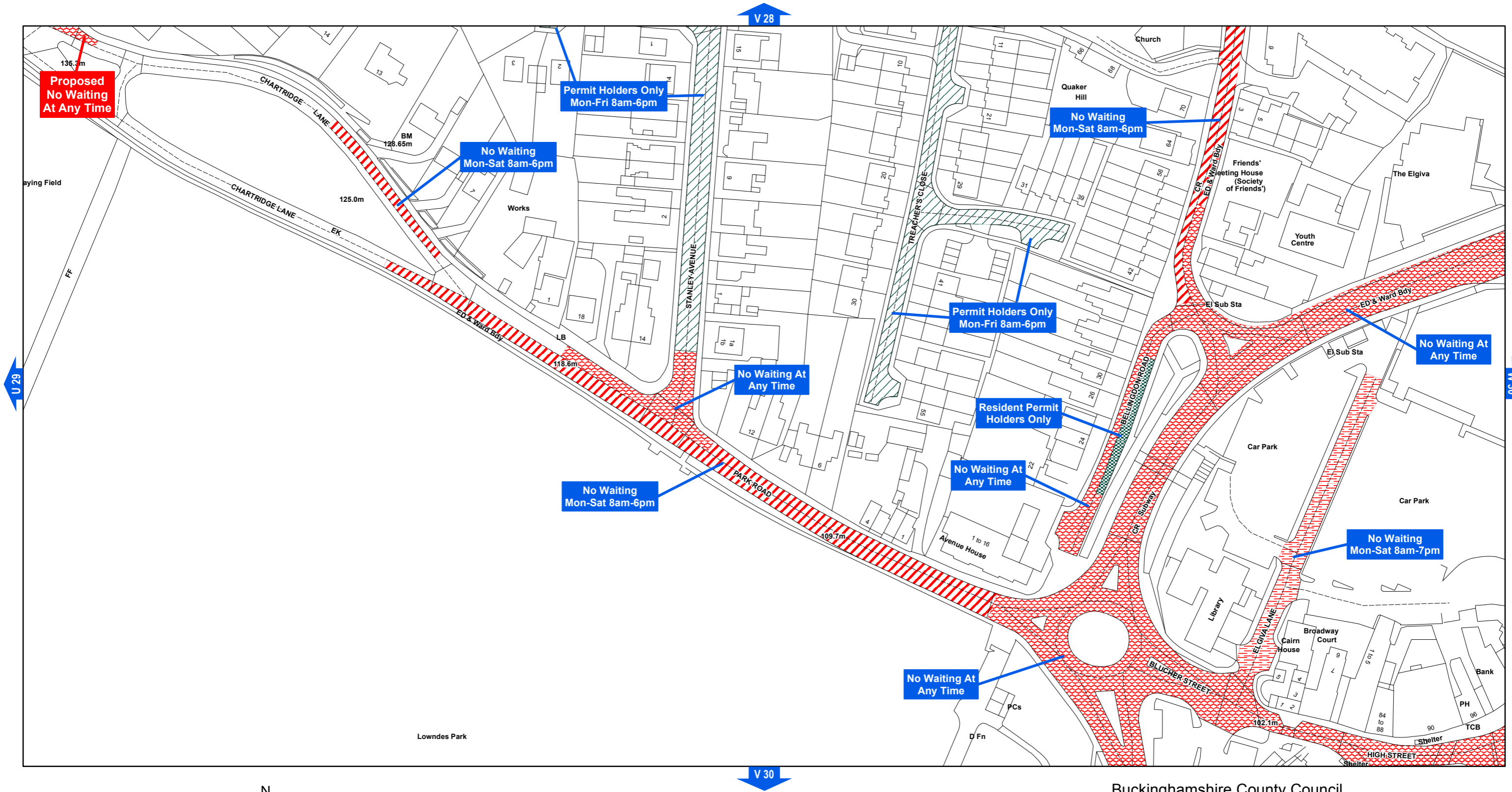

SCALE - 1:1250 At A3



KEY

- Existing Restriction
- Proposed Restriction



The Buckinghamshire County Council (Chiltern District) (Consolidation) Order 2010

Buckinghamshire County Council
 County Hall
 Walton Street
 Aylesbury
 Buckinghamshire HP20 1UY

Produced from Ordnance Survey 1:1250 mapping with permission of the Controller of Her Majesty's Stationery Office © Crown Copyright. Unauthorised reproduction infringes Crown Copyright and may lead to prosecution or civil proceedings. © Buckinghamshire County Council. 100021529 2016

AREA CODE: W 27

SHEET REVISION NUMBER - 3

CONSULTATION PLAN

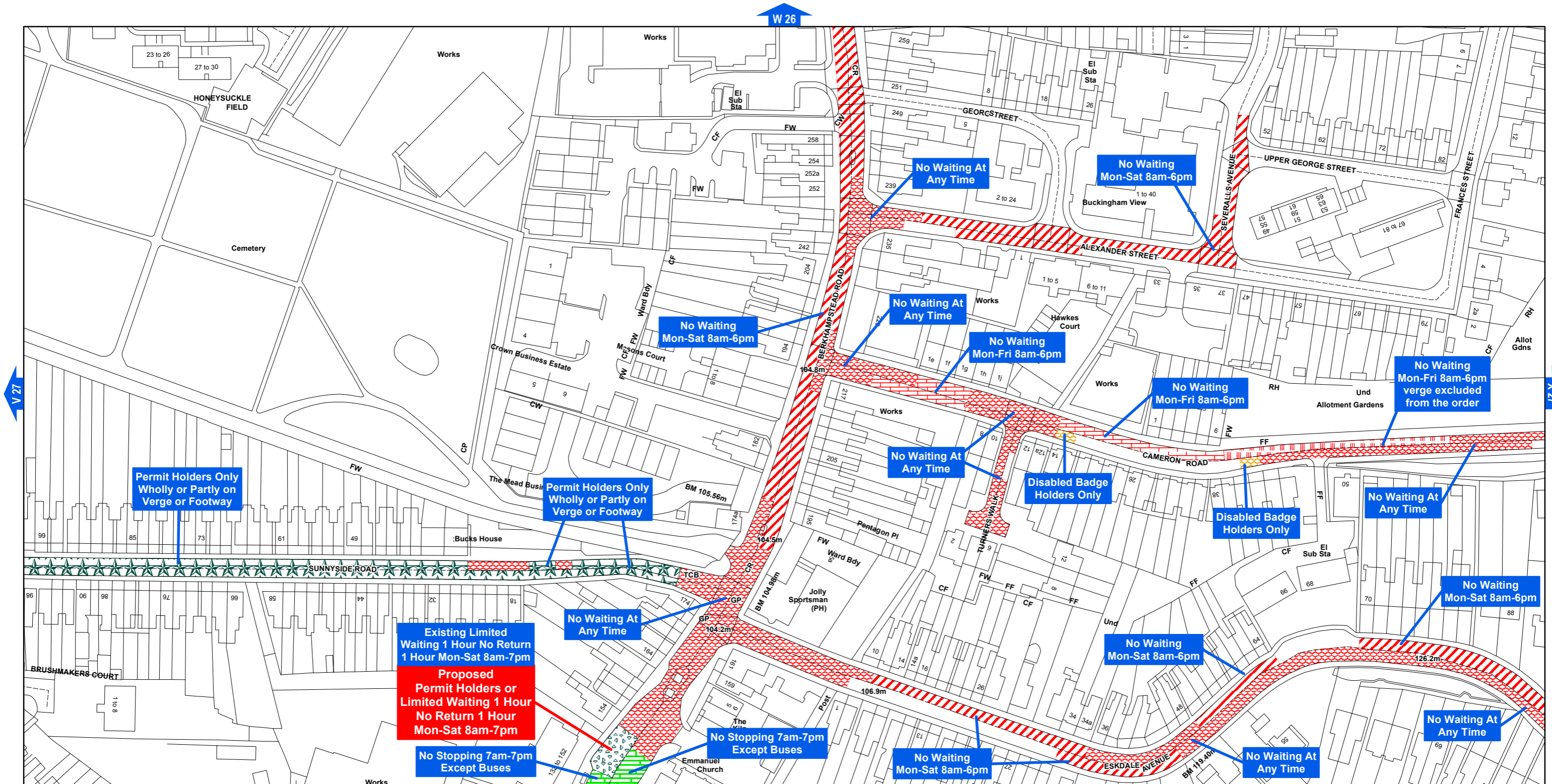

SCALE - 1:1250 At A3



KEY

- Existing Restriction
- Proposed Restriction



Buckinghamshire County Council
 County Hall
 Walton Street
 Aylesbury
 Buckinghamshire HP20 1UY

The Buckinghamshire County Council (Chiltern District) (Consolidation) Order 2010

Produced from Ordnance Survey 1:1250 mapping with permission of the Controller of Her Majesty's Stationery Office © Crown Copyright. Unauthorised reproduction infringes Crown Copyright and may lead to prosecution or civil proceedings. © Buckinghamshire County Council. 100021529 2016

AREA CODE: W 28

SHEET REVISION NUMBER - 3

CONSULTATION PLAN

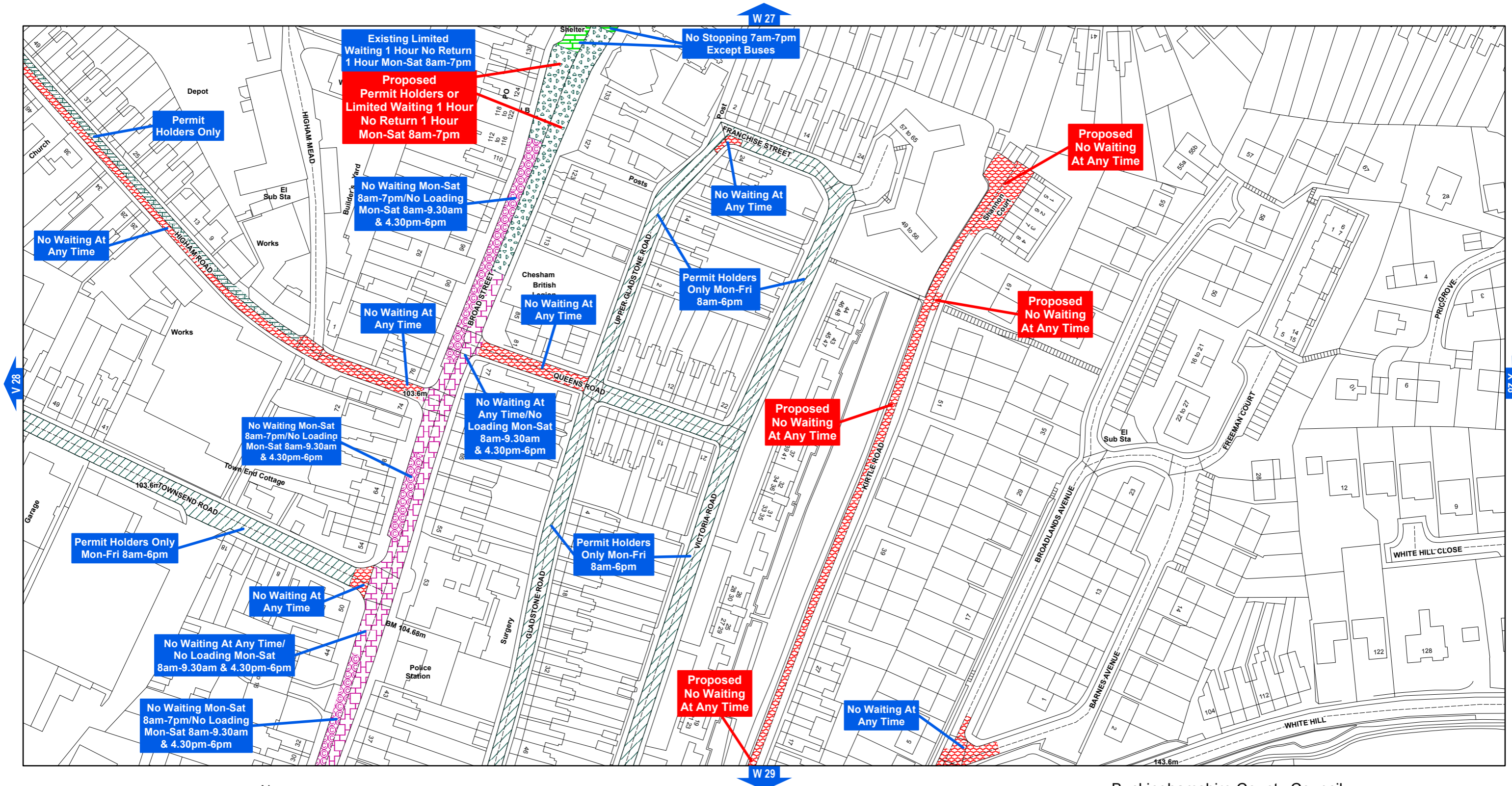

SCALE - 1:1250 At A3



KEY

- Existing Restriction
- Proposed Restriction



The Buckinghamshire County Council (Chiltern District) (Consolidation) Order 2010

Buckinghamshire County Council
 County Hall
 Walton Street
 Aylesbury
 Buckinghamshire HP20 1UY

Produced from Ordnance Survey 1:1250 mapping with permission of the Controller of Her Majesty's Stationery Office © Crown Copyright. Unauthorised reproduction infringes Crown Copyright and may lead to prosecution or civil proceedings. © Buckinghamshire County Council. 100021529 2016

AREA CODE: W 29

SHEET REVISION NUMBER - 3

CONSULTATION PLAN

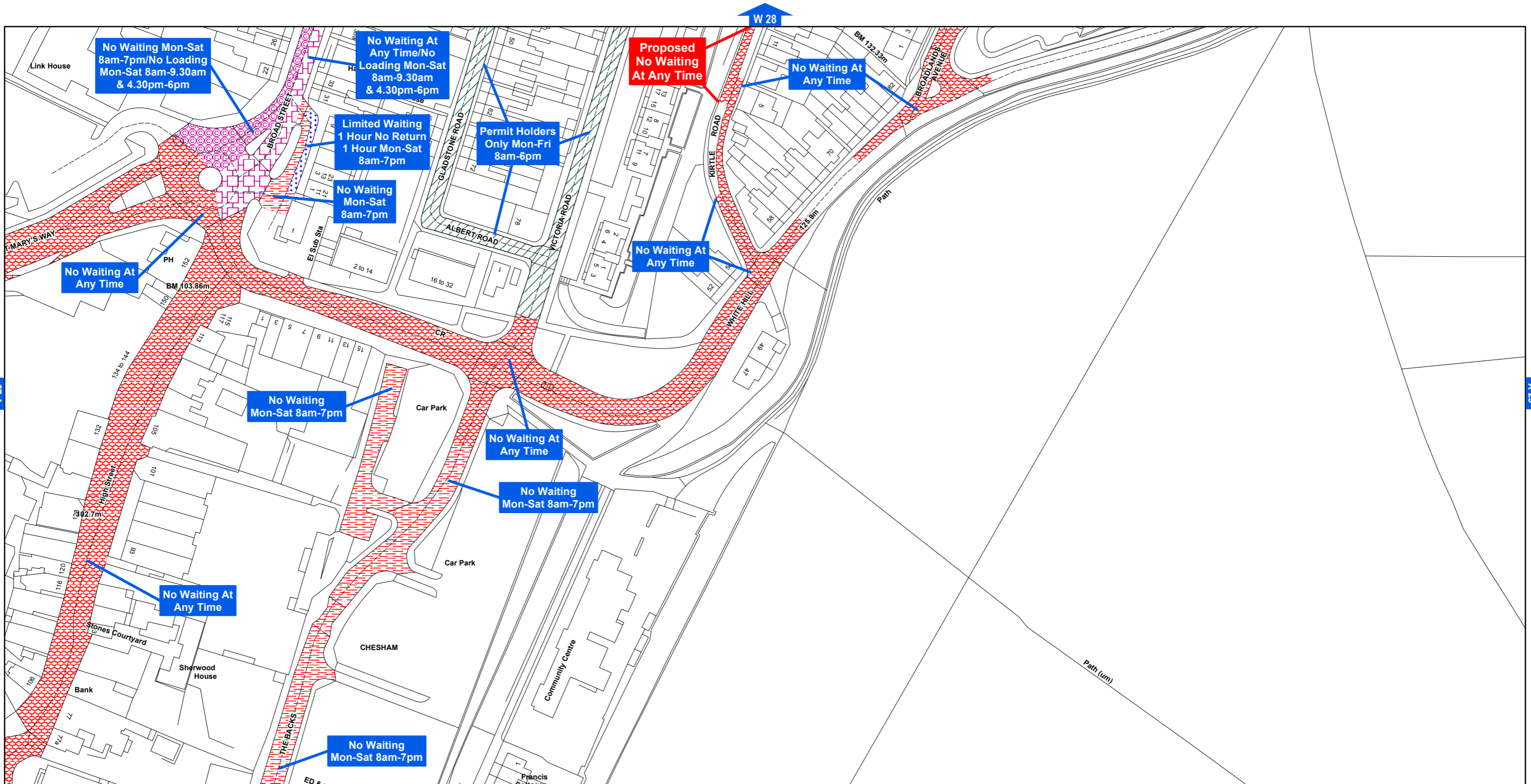

SCALE - 1:1250 At A3



KEY

- Existing Restriction
- Proposed Restriction



The Buckinghamshire County Council (Chiltern District) (Consolidation) Order 2010

Buckinghamshire County Council
 County Hall
 Walton Street
 Aylesbury
 Buckinghamshire HP20 1UY

Produced from Ordnance Survey 1:1250 mapping with permission of the Controller of Her Majesty's Stationery Office © Crown Copyright. Unauthorised reproduction infringes Crown Copyright and may lead to prosecution or civil proceedings. © Buckinghamshire County Council. 100021529 2016

AREA CODE: X 28

SHEET REVISION NUMBER - 3

CONSULTATION PLAN

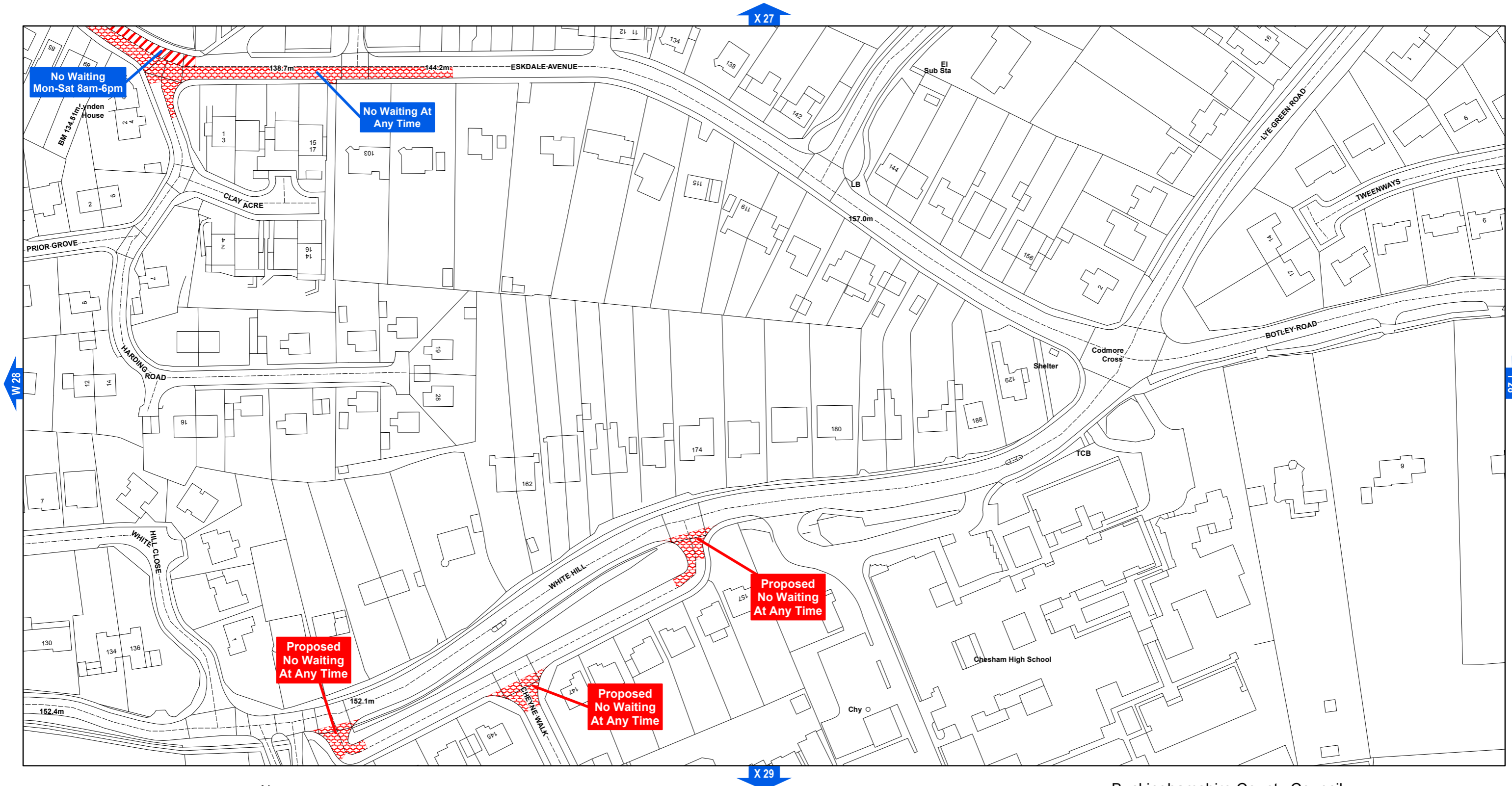

SCALE - 1:1250 At A3



KEY

- Existing Restriction
- Proposed Restriction



Buckinghamshire County Council
 County Hall
 Walton Street
 Aylesbury
 Buckinghamshire HP20 1UY

The Buckinghamshire County Council (Chiltern District) (Consolidation) Order 2010

Produced from Ordnance Survey 1:1250 mapping with permission of the Controller of Her Majesty's Stationery Office © Crown Copyright. Unauthorised reproduction infringes Crown Copyright and may lead to prosecution or civil proceedings. © Buckinghamshire County Council. 100021529 2016